

Alimak FC 6200-12

Model FC 28/37 TD Single Car Construction Hoist

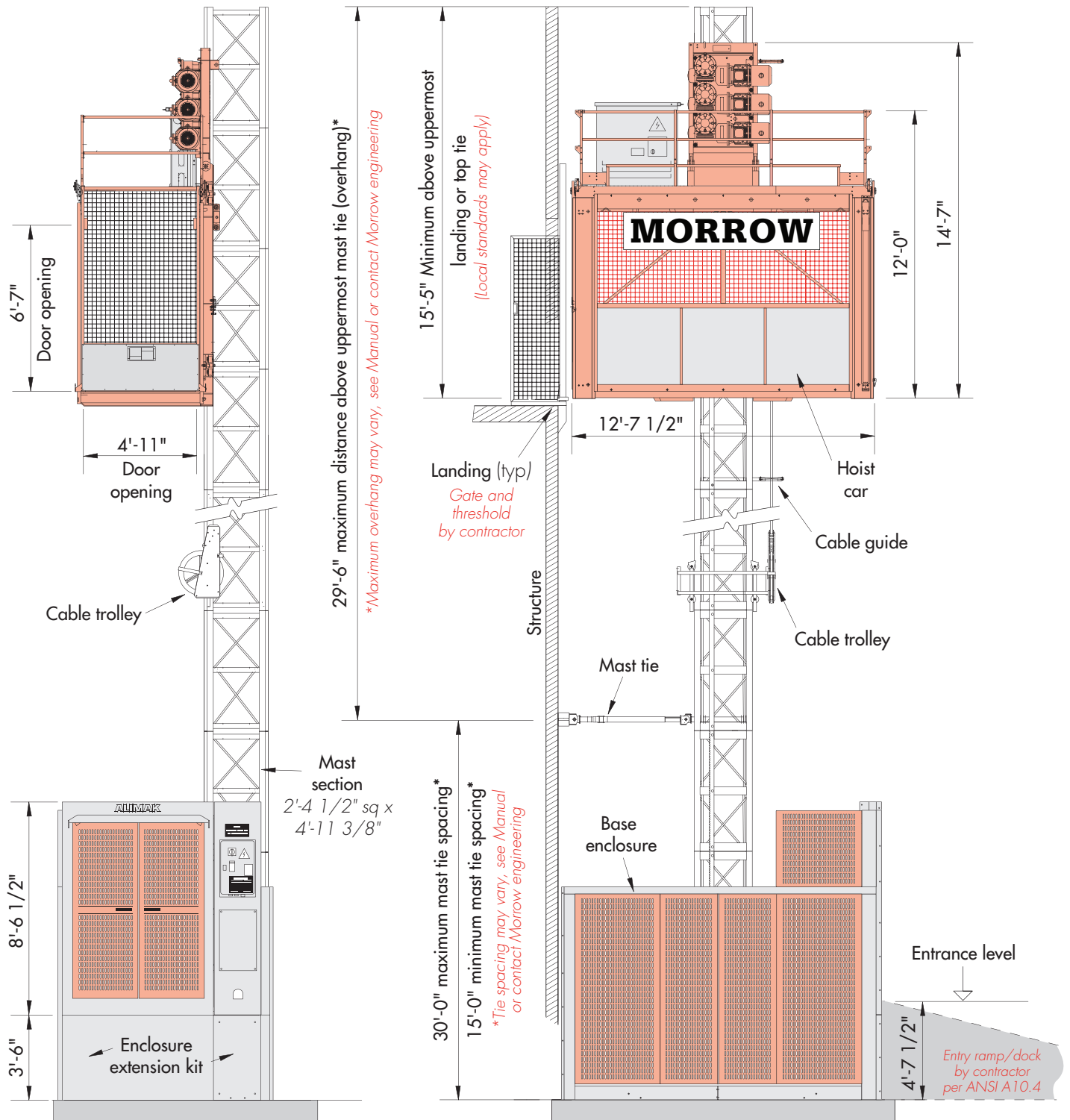

Morrow Equipment

Foundation Details

FC 6200-12 Single

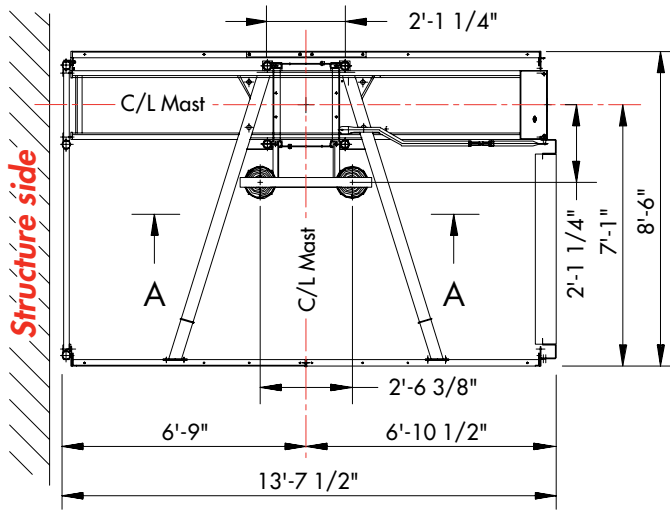

Plan View
Base enclosure

IMPORTANT! Verify that the use of a slab foundation conforms to all applicable federal, state and local standards and codes PRIOR to foundation installation.

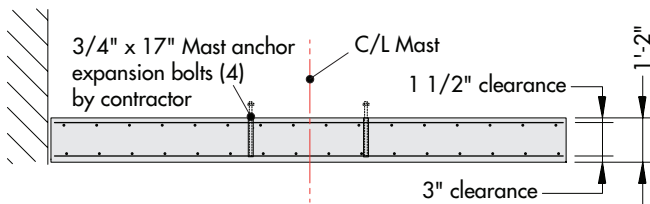

Elevation (Concrete slab)

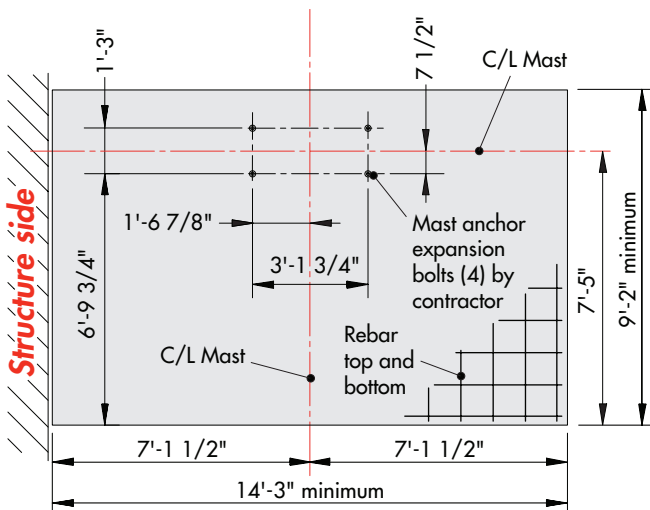

Plan View
Concrete slab

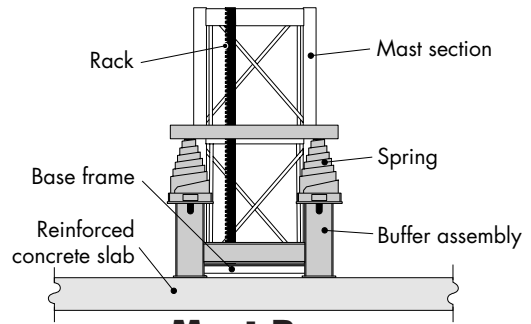

Mast Base
Section A-A

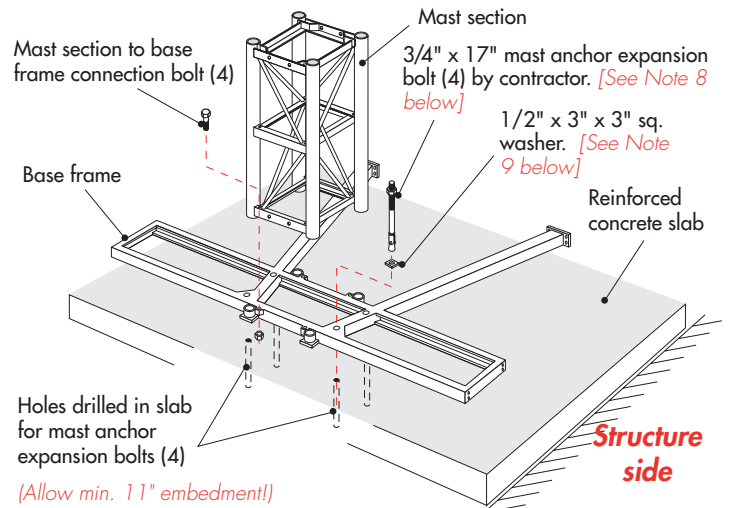

Foundation Detail

Note! Distance from building face to center of mast depends on the type of mast tie installed. Alternate anchoring methods available. Refer to Manual or contact Morrow Equipment for information.

NOTES

1. Foundation slab: 14'-3" x 9'-2" x 1'-2" with 3,500 psi concrete.
2. Reinforcing bars are #5 ASTM 615-60 10" o.c. each way.
3. Foundation based on 490-foot mast height. For greater heights, contact Morrow engineering department.
4. Foundation pad designed for a minimum soil bearing of 1,000 psf.
5. Alternative pit foundation available. Contact Morrow for information.
6. Refer to the manufacturer's manual before installing, operating, servicing, repairing, jumping or dismantling hoist.
7. For alternate configurations, contact Morrow Equipment for additional information.
8. 3/4" x 17" Williams™ High Tensile Spin-Lock Anchor Bolt and nut assembly. (R1S06C14 Head assembly with ASTM A109/C1045 bolt and nut) or approved equivalent. Bolt by contractor. Install according to bolt manufacturer's requirements. Drill holes 1 3/4-in diameter allowing for 1 1/2" embedment. Bolt is also available through Morrow upon request. R1S-type anchor bolts not intended for use at extreme cold temperatures.
9. 1/2" x 3" x 3" sq. washer ASTM A36 steel plate by contractor. Washer also available from Morrow upon request. Drill hole = 1 3/16" dia. at centerline.

Tie Details

FC 6200-12 Single

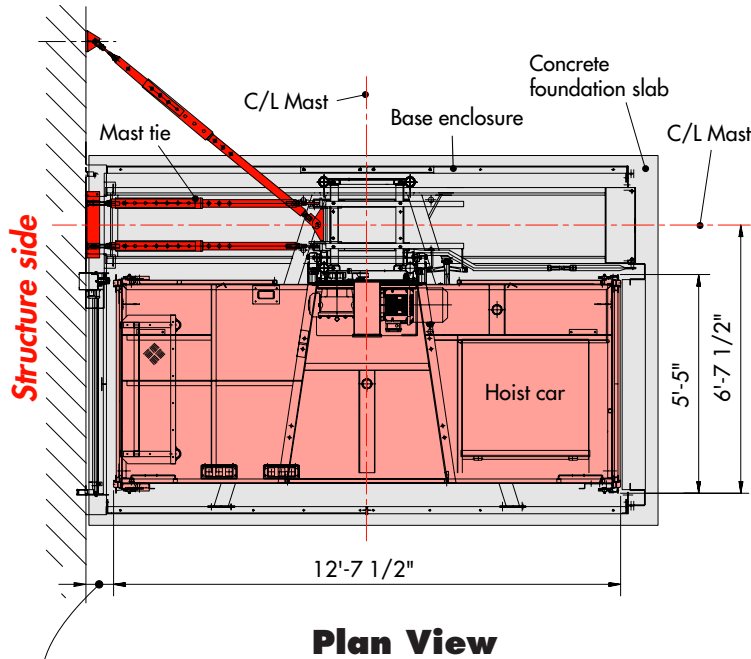

IMPORTANT! ANSI A10.4 11.3 specifies a 1/2" (min.) to 2 1/2" (max.) clearance between car platform sill and landing sill. Verify before installing to assure compliance with appropriate standards, codes and regulations.

Note! Hoist cars are equipped with doors at each end. An optional side door with a 10'-6" x 6'-7" opening is available. Contact Morrow for more information.

Note! The tie-in connections shown below are examples of typical installations. Please note, however, that factors affecting the type of tie-in to be used may vary due to project specific criteria.

Verify all dimensions before installation. See Manual for additional information or contact Morrow.

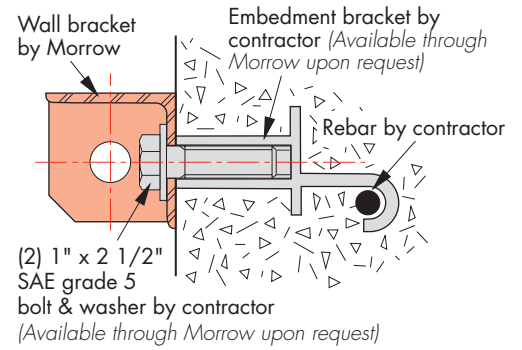

Mast Tie Connection
Alternate A - Side view

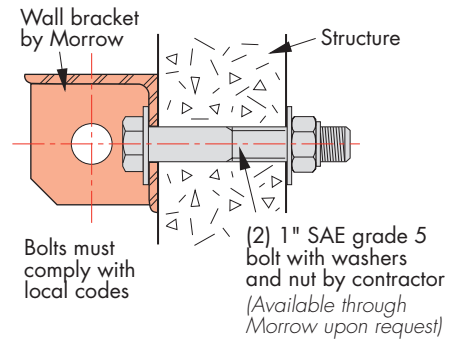

Mast Tie Connection
Alternate B - Side view

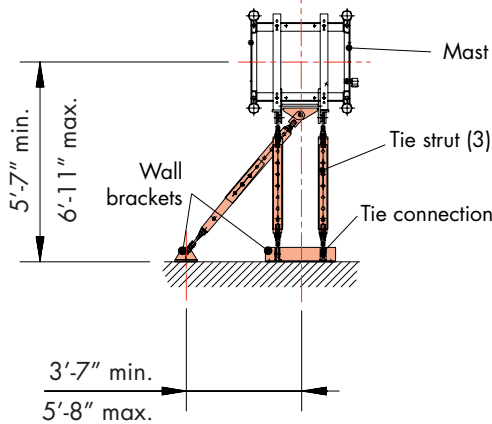

Standard Mast Tie
Plan view

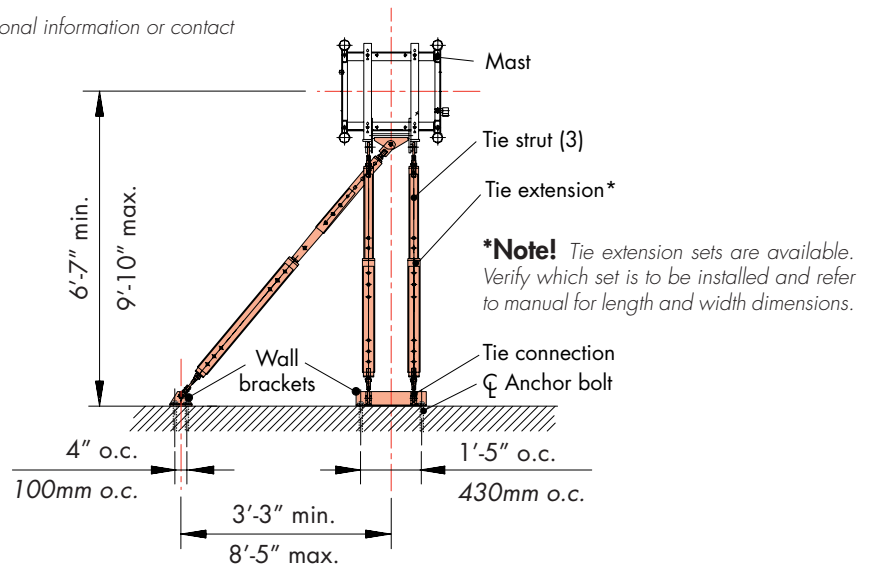

Extended Mast Tie*
Plan view

***Note!** Tie extension sets are available. Verify which set is to be installed and refer to manual for length and width dimensions.

SPECIFICATIONS

Alimak® Personnel and Material Hoist Single Car Model Scando FC 6200-12

GENERAL

| | | | |
|-----------------------------------|----------------------------|-------------------------------------|----------|
| Load capacity | 6,200 lbs | Max. height on standard masts | 490' |
| Number of passengers | 30 | Max. freestanding mast height | 30'-0" |
| Car inside dimensions (approx.).. | 12'-2" x 4'-11" x 7'-3" | Maximum mast overhang * | 29'-6" |
| Door opening | 6'-7" x 4'-11" | Maximum mast tie spacing * | 30'-0" |
| Mast section length | 4'-11 3/8" | Minimum mast tie spacing * | 15'-0" |
| Speed | 0 - 157 fpm | Power supply | 125 Amps |
| Motors | 3 x 15 hp | Starting current | 170 Amps |
| Power requirement..... | 480 Volt - 3 phase - 60 Hz | Power consumption..... | 87 kVA |

* Overhang and mast tie spacing figures may vary. Consult equipment manual or contact Morrow engineering for specific information.

WEIGHTS

| | | | |
|-----------------------------------|-----------|----------------------------------|-----------|
| Base enclosure (without car)..... | 2,330 lbs | Hoist car (only)..... | 5,370 lbs |
| Base enclosure (with car)..... | 7,700 lbs | Mast section (single rack) | 286 lbs |

SAFETY FEATURES

- Electronic and mechanical door interlocks on hoist car and base enclosure doors.
- Safety hooks assure hoist car is securely attached to mast.
- Automatic stop and final limit switches limit hoist car travel when reaching end positions.
- Phase failure relay system prevents hoist operation unless correct phase sequence is connected.
- Governor prohibits excessive drive speed.
- Main "ON/OFF" switch lockable to prevent unauthorized operation.
- Spring buffers.
- NO counterweights required.

INSTALLATION

- Adding mast sections does not require special equipment.
- For instructions regarding the installation of the model FC 28/37 TD single car hoist, refer to the manufacturer's manual.
- Specifications and equipment shown are subject to change without prior notification.
- Drawings are for illustrative purposes only. Do not scale.
- This product must be used in a safe manner. Furthermore, the use of this product and its components must be in conformity with manufacturer's specifications and in compliance with all applicable standards, codes, regulations, etc.

Please refer to manufacturer's manual when installing, operating, servicing, repairing, jumping or dismantling hoist. This datasheet contains information for "typical" FC 6200-12 installation, i.e., configured for car on left-hand side of mast (when viewing hoist from side opposite structure). For alternate configurations and special applications, contact Morrow Equipment for information.



Morrow Equipment

C O M P A N Y, L. L. C.

3218 Pringle Road SE • P O Box 3306 • Salem, Oregon 97302-0306 USA
Tel. 503.585.5721 • Fax. 503.363.1172 • www.morrow.com

The American home of
LIEBHERR
TOWER CRANES

Atlanta, GA • Charlotte, NC • Chicago, IL • Denver, CO • Honolulu, HI • Houston, TX • Los Angeles, CA • Millwood, NY • Milwaukee, WI
Pensacola, FL • St. Louis, MO • San Francisco, CA • Dallas, TX • Seattle, WA • Miami, FL • Tampa, FL • Washington, DC
Sydney, Australia • Brisbane, Australia • Auckland, New Zealand • Wellington, New Zealand • Vancouver, BC, Canada • Toronto, ON, Canada • Mexico City, Mexico